

New York

Design by BoConcept

Samvejledning - Assembly Instructions - Montageanleitung - Instructions d'assemblage - Instrucciones de montaje

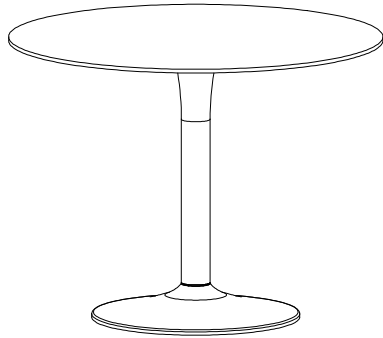

370-T058

370-1670 and 370-1680
Max 40 Kg
75,3 x 99 cm

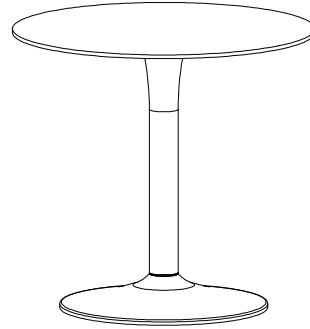

370-T059

370-1680 and 370-1690
Max 30 Kg
75,3x80 cm

370-1670

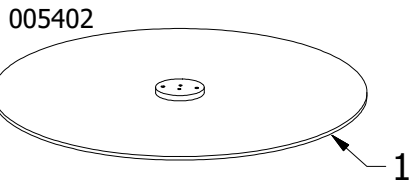

370-1690

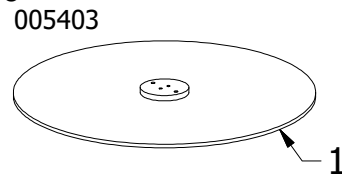

370-1681

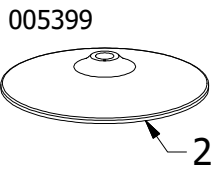

370-1682

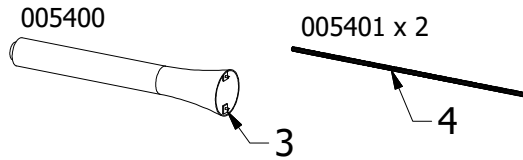

370-1682

Beslag - Beschläge - Fittings - Set de montage
937000044



A x 2
970001205
M10 Nut



B x 2
970001741
M10 Lock nut



C x 1
005418



D x 4
970001758



E x 2
970001759



F x 2
970001760

Værktøj - Werkzeuge - Tools - Outils



FIG.
1

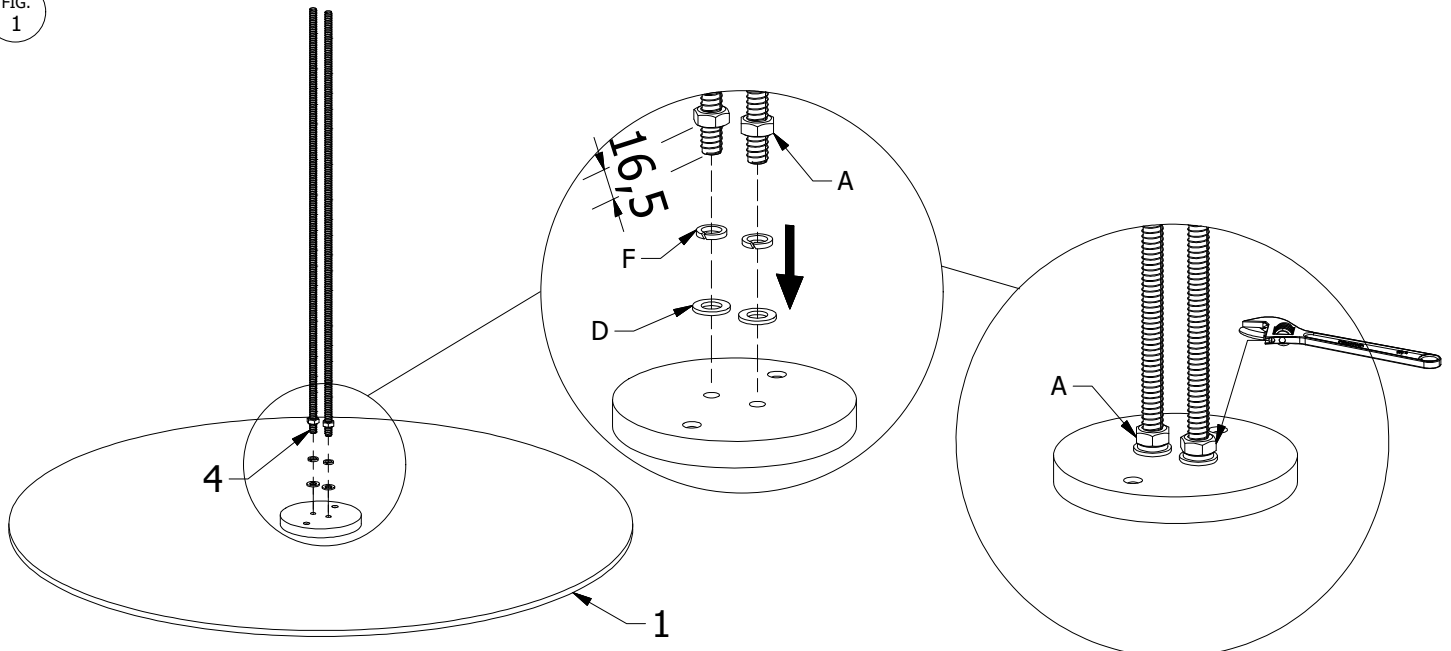
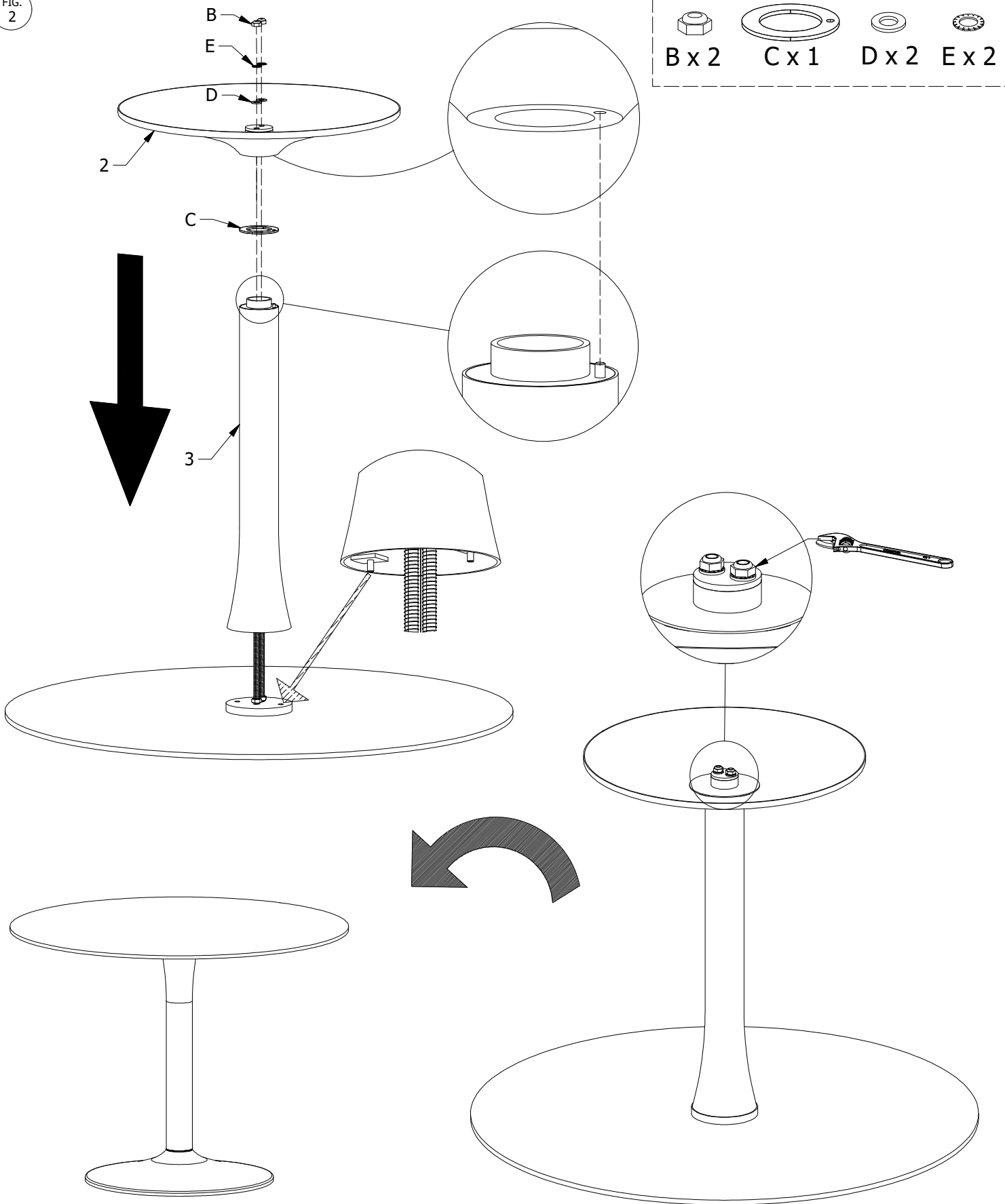

FIG. 2



DK Ved reklamation oplyses følgende:
 D Im Reklamationsfall, bitte folgendes erläutern:
 US In case of claims, please state the following:
 F En cas de réclamation, veuillez indiquer:
 NL Bij service volgene mededelen
 E En caso de reclamación, indicar lo siguiente:
 P No caso de reclamação, por favor indique o seguinte:
 JP お気づきの点等ございましたら、以下の点をお知らせください。

Example!

Korpus - Korpus - Carcase - Carcasse 			Beslag - Fittings - Beschläge - Set de Montage 		
--	--	--	--	--	--